



FORD EVEREST 2015- FRONT MOUNT INTERCOOLER UPGRADE FITTING INSTRUCTIONS

WARNING

WARNING: Failure to follow this procedure will void your warranty.

- Do not use this product in any other motor vehicle for which it is not designed.
- Do not use any other mounting location / method other than described in this instruction.
- It is advisable to seek assistance of another person when installing this product.
- Do not repair or modify this product and / or its mounting bracket in any way - repair or modification may affect proper operation of the vehicle or cause destruction of property.
- Be sure to clean and remove any loose debris before removing pipe work as debris entering the engine could be detrimental to the engine and or components

If the vehicle is fitted with a bull bar it is normally possible to install the intercooler without removing the bar. If the vehicle still has the factory bar it will need to be removed.

Start by removing the engine cover and top plastic trim between the grill and radiator support. A flat blade screwdriver works best.



For ease of access remove the airbox lid and pipe to turbo. Remove the factory intercooler hoses. We retain the plastic pipework from the turbo to the front crossmember. Remove mounting bolts for the intercooler. The radiator shroud will need to be lifted out of the lower supports to allow removal of the intercooler. The shroud does not need to be removed completely. Lean back shroud and remove intercooler.

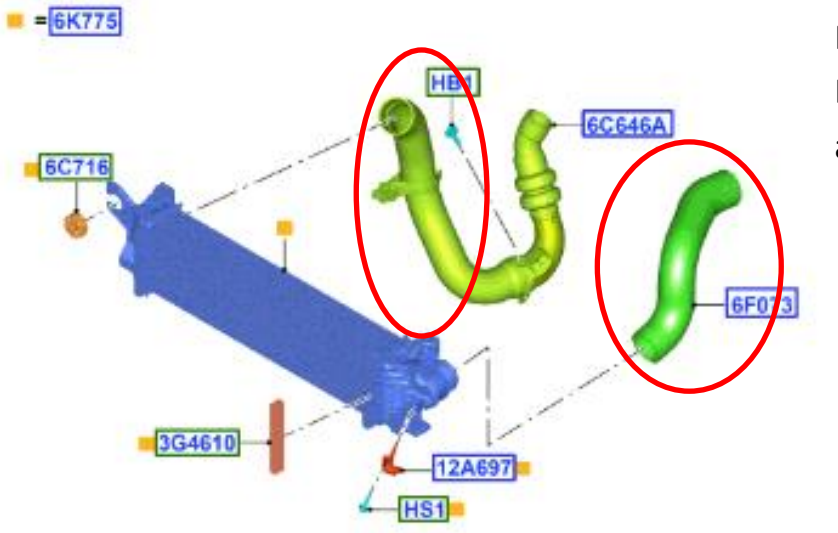
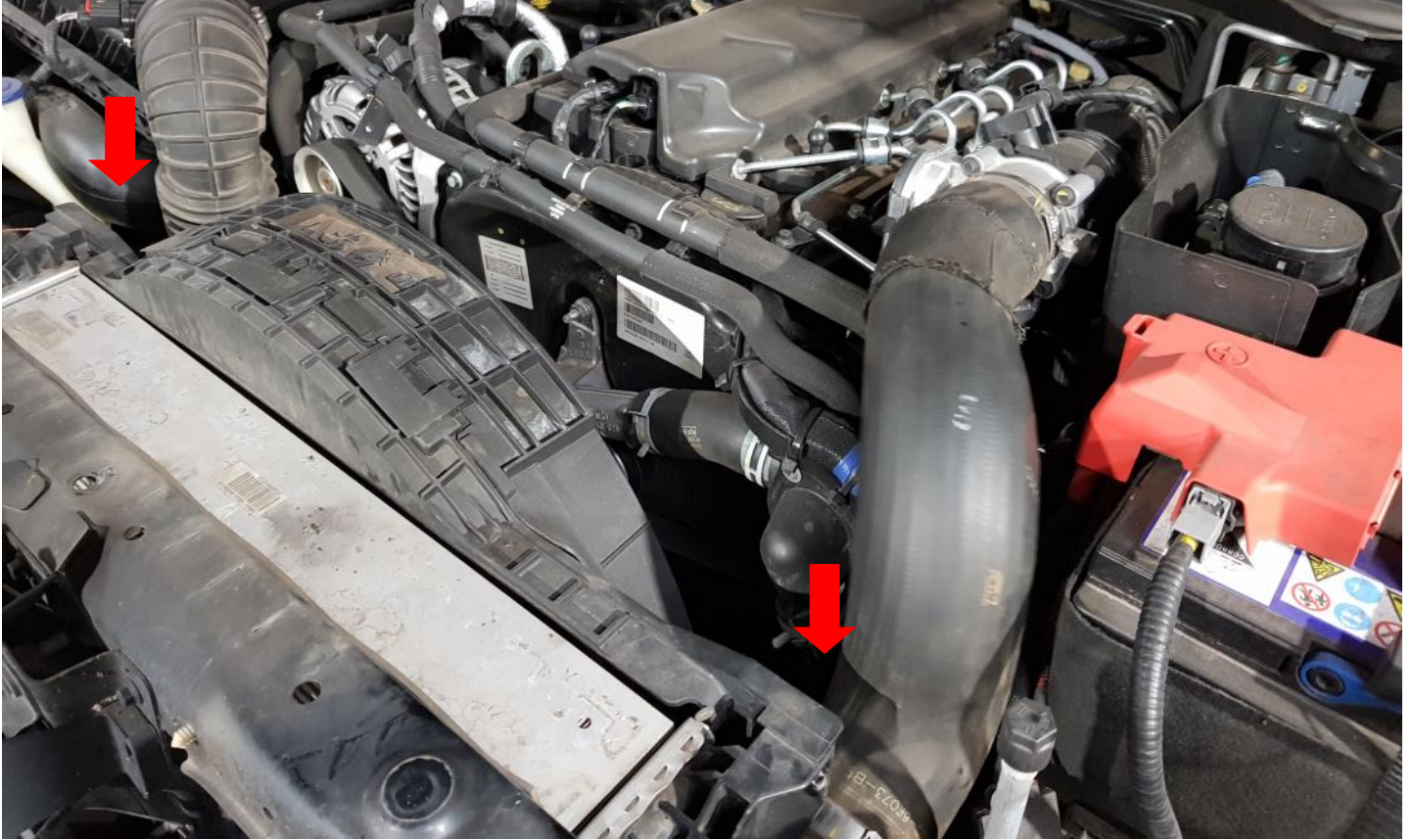

Remove intercooler pipes circled. Leave plastic pipe from turbo attached.



Remove factory plastic ducting shown. Remove horns from factory mount.

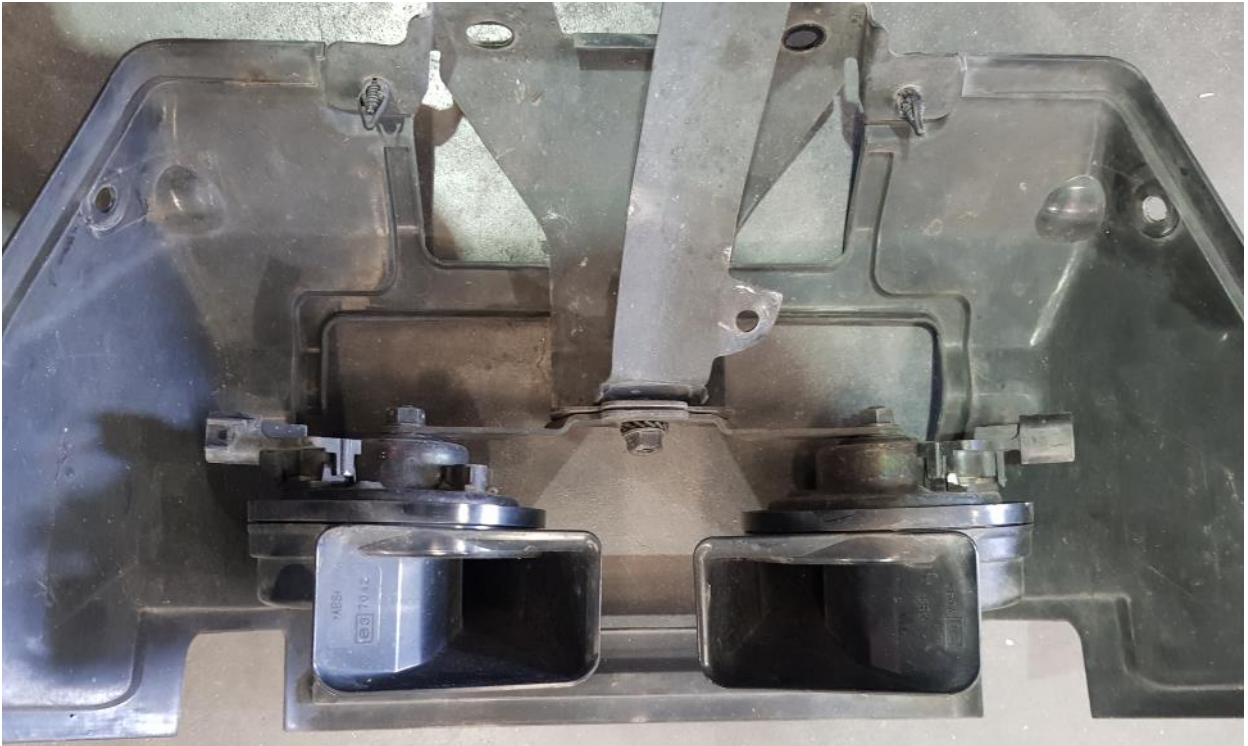

Remove the two factory rubbers and crush tubes from the intercooler and install on the shroud support brackets. Remove the temp sensor from the factory intercooler and install on the Cross country intercooler using the supplied m6x10 allen bolt.

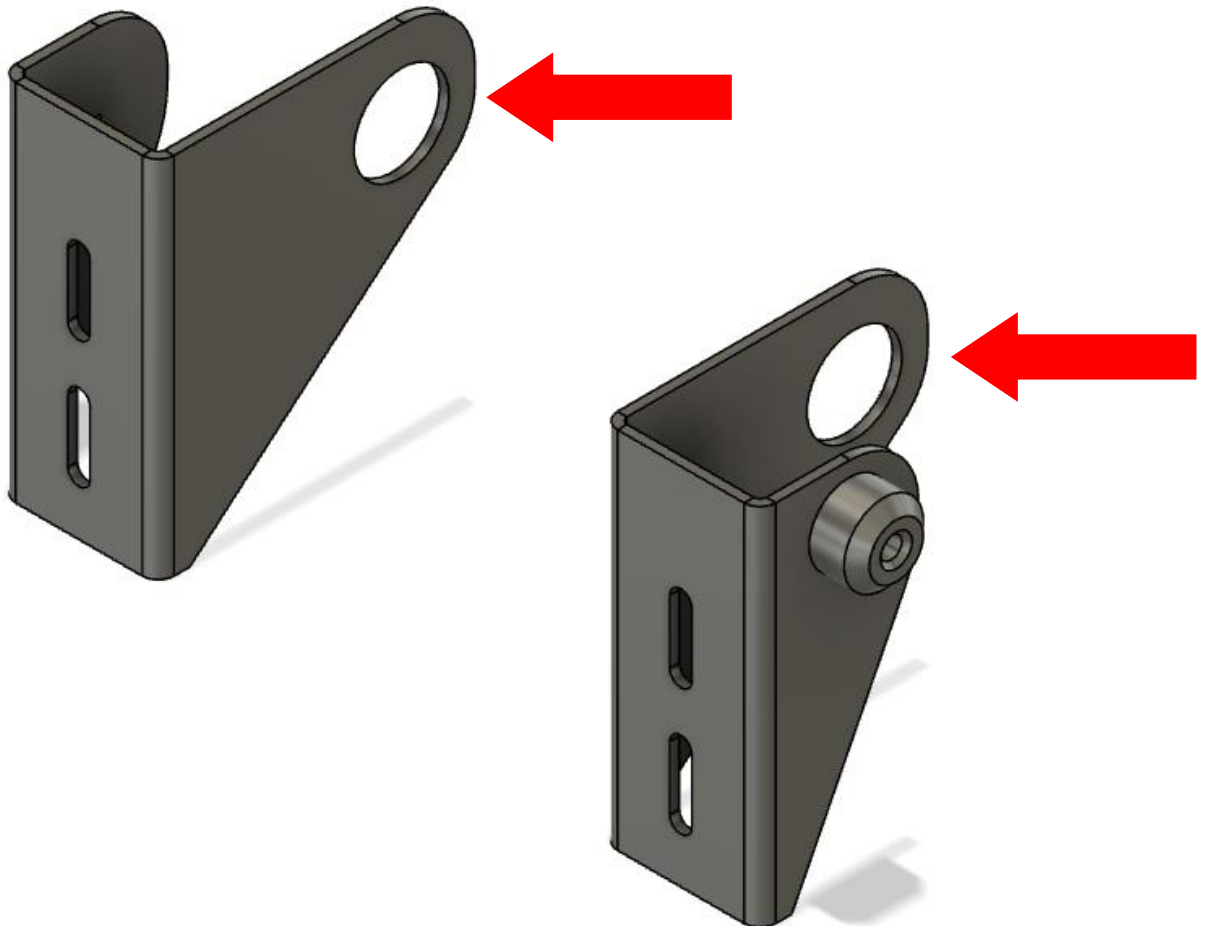
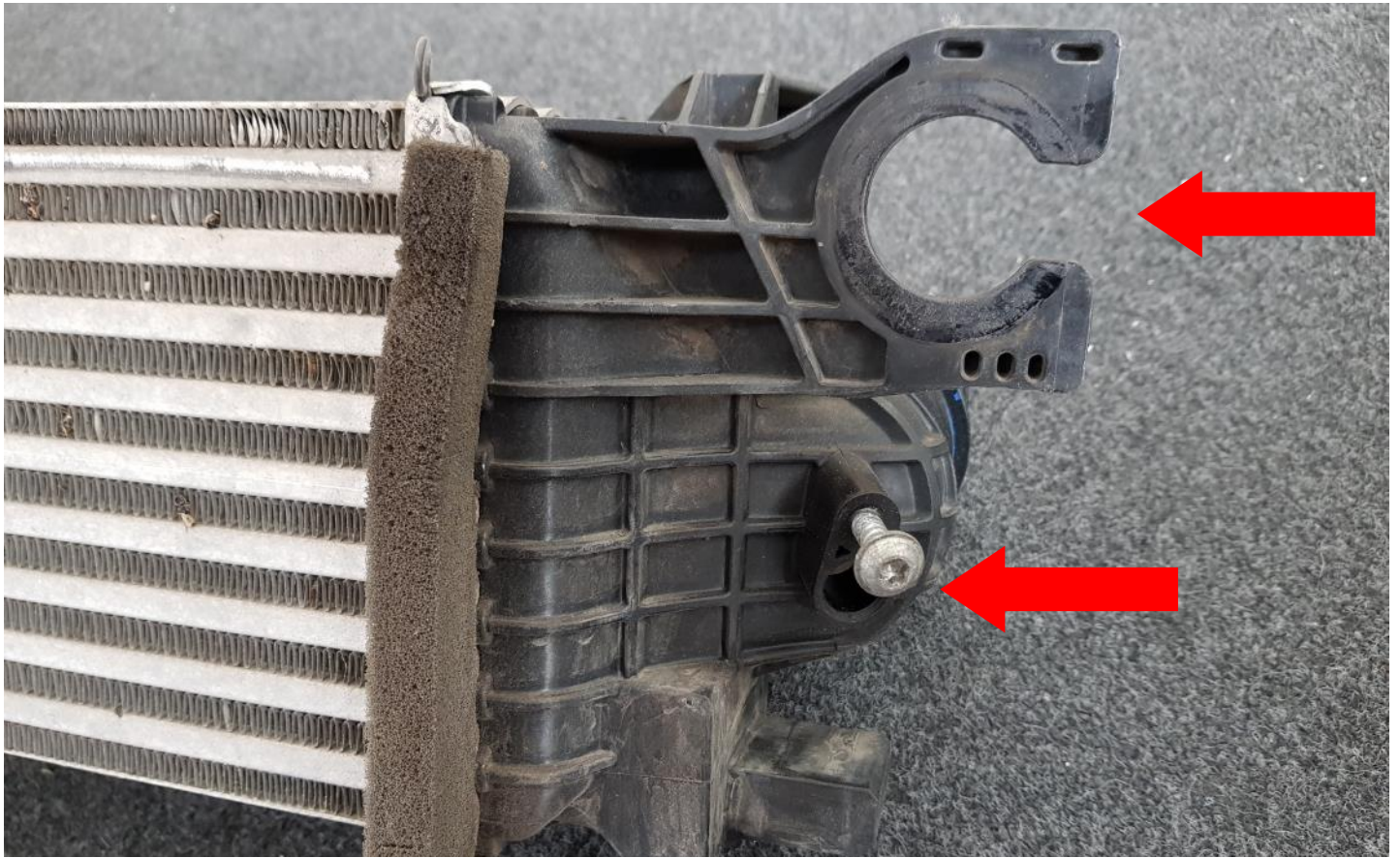

Install the two small air ducting shrouds as shown using supplied bolts.



Install the 4 supplied rubbers to the intercooler mounting points. Place the intercooler in position and install the crush tubes followed by the panel washer and m6x40 bolts. Connect the temp sensor wire. This will have to be ran through the same hole as the intercooler pipe on the passenger side.

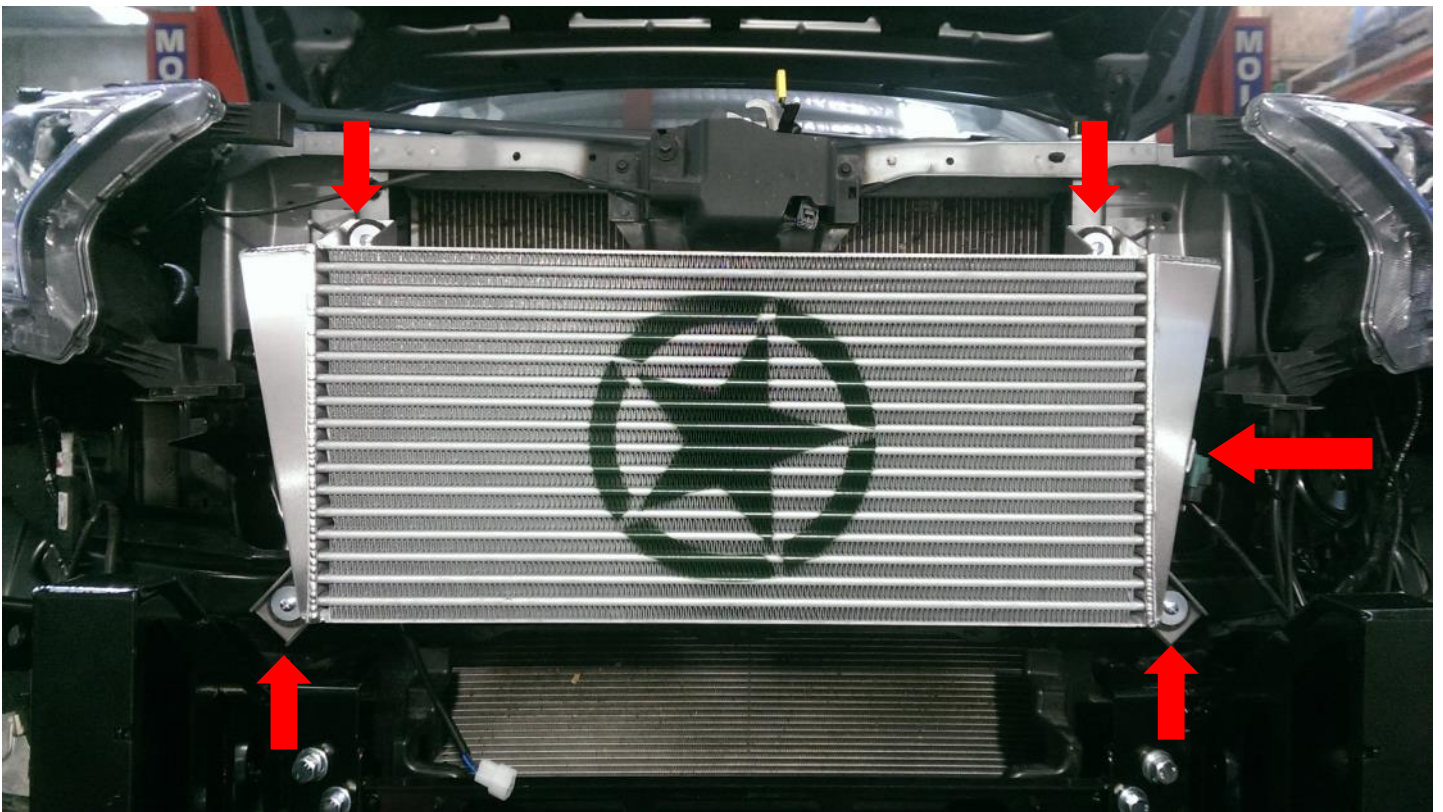

For clearance to the intercooler pipework the return line from the radiator to overflow bottle will need to be unclipped and secured into place using supplied cable ties and adhesive mounts

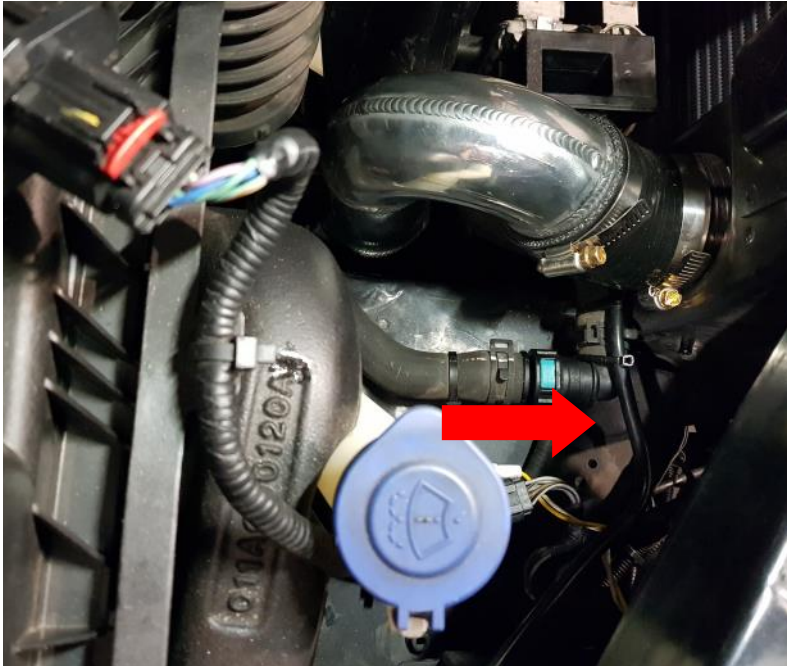

Gently bend the AC to the passenger side of the vehicle to allow clearance for the intercooler pipework. The corner of the fan shroud can be trimmed for clearance if needed.

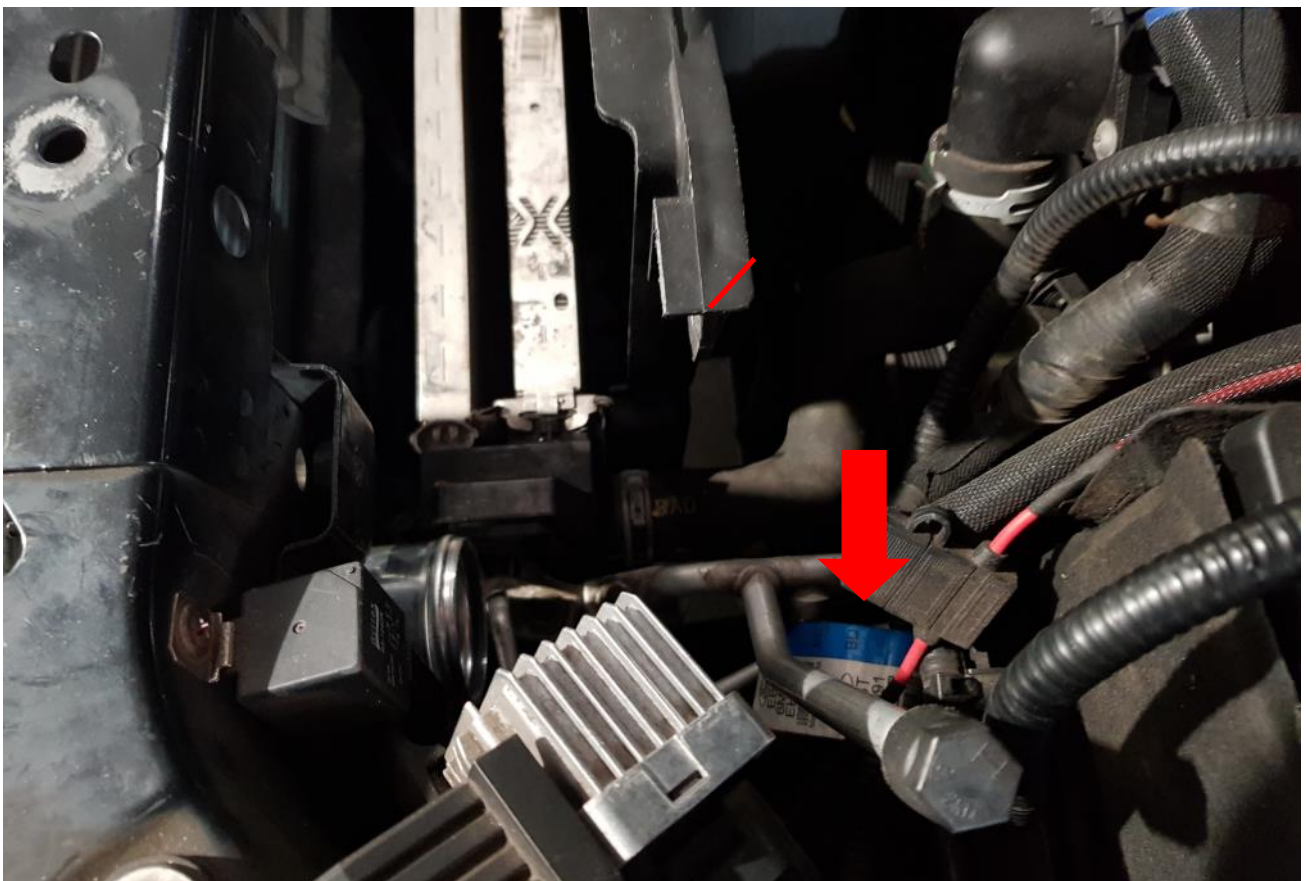

Next install the large shroud below followed by the shroud support brackets. Reinstall the fan shroud and secure to support brackets with supplied m8x16 bolts to the fan shroud. Leave brackets loose and install pipework.

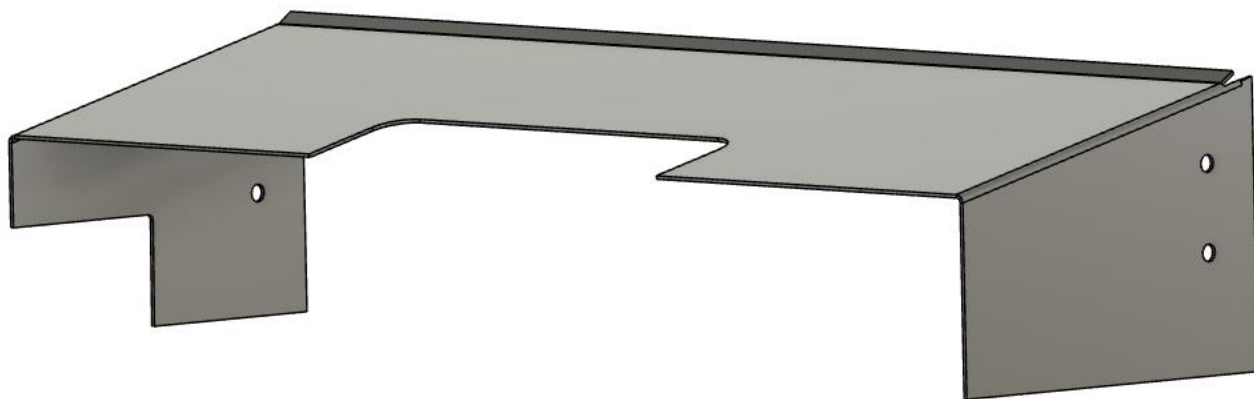

Before installing pipework. Clean the throttle body and lower turbo hose using brake cleaner or similar so no oil is present on the mating surfaces. Locate the 57-63mm 90 degree silicone reducer. Install the 57mm end to the passenger side of the intercooler. Install hose clamps loose. Install the short end of the aluminum bend into the 90 degree reducer slide hose clamps over and install the 63mm 45 degree silicone to throttle body. Adjust and tighten all clamps.

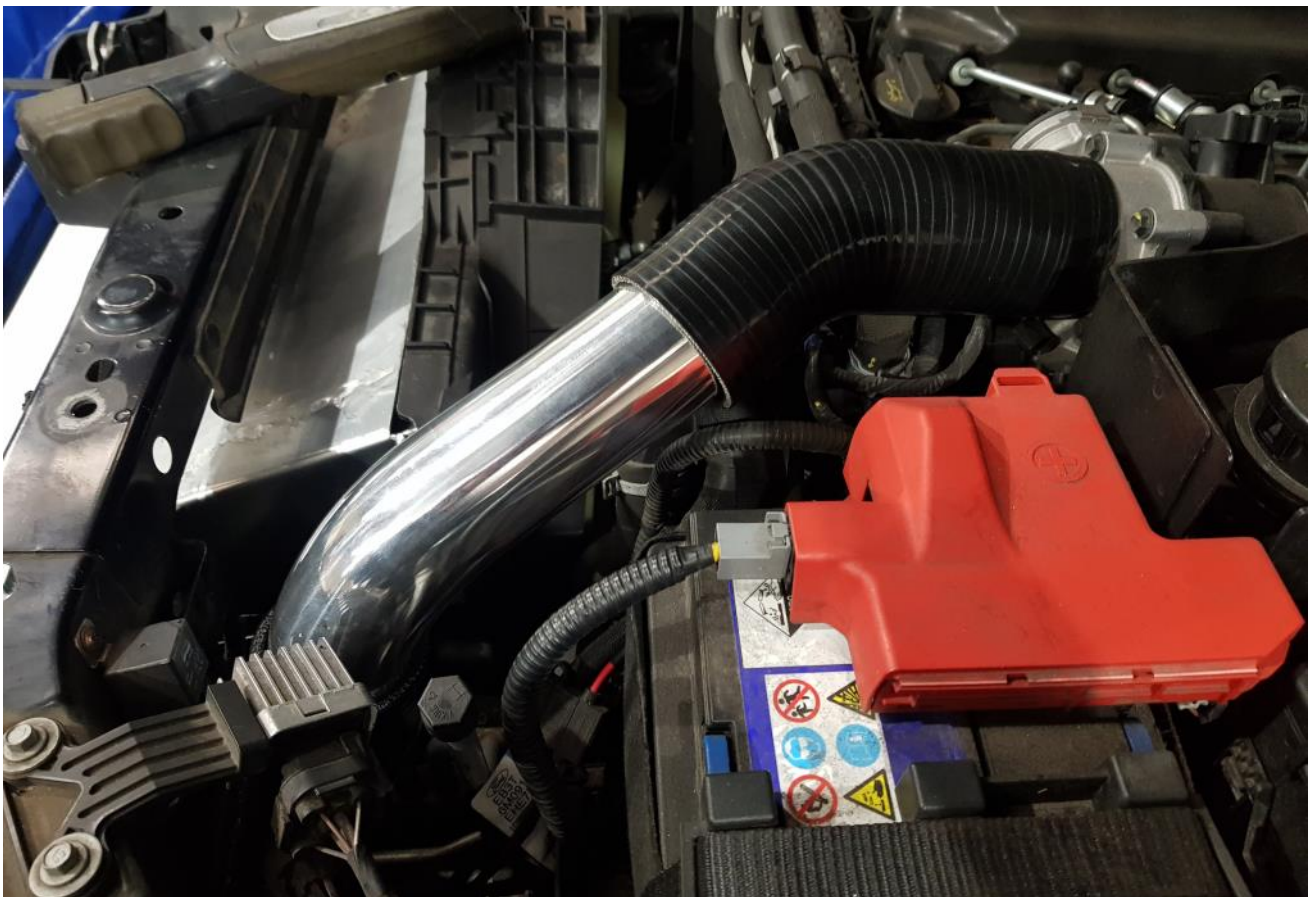

Install the 63-70mm silicone reducer to the factory pipe coming from the turbo. For ease of fitment adjust to approx. position and tighten hose clamp on the 70mm end. Install the short 45 degree 57mm silicone to the intercooler. Install hose clamps loosely. Install the aluminum pipe between the two. Loosen lower hose clamp and adjust pipework and tighten all hose clamps.



With pipework installed, install turbo pipe support bracket as shown using supplied M8x25 bolt. Reinstall shroud mounting bolts both sides. Adjust large shroud and install with the M6 panel bolts supplied. Reinstall airbox lid and airbox to turbo pipe.

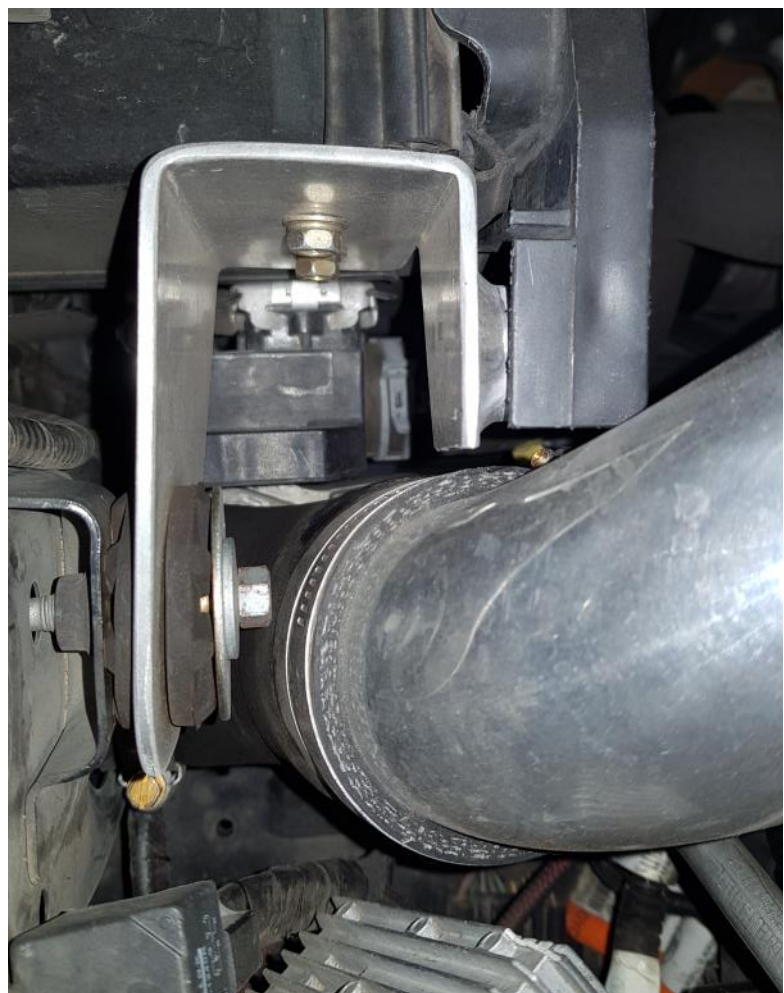



Install horns using brackets shown in position shown on above picture. Reconnect wires.

Cable tie up loose wiring along horn wiring loom.

Drivers side

Passenger side

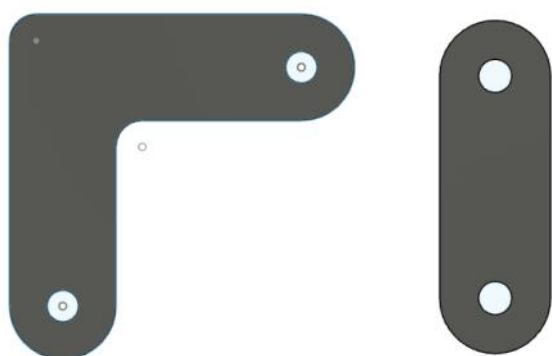

Double check all hose clamps and fixings are tight. Reinstall bumper, grill, and plastic trim.

Test drive vehicle. After 100km of driving re tension hose clamps and check at regular service intervals.

If hoses are removed clean the inside end of the hoses and mating surfaces so no oil is present at time of re installation.